

## technical sheet

## DYNAFOR LLX LCD load indicators capacities : 250 kg to 250 t

réf. : T 2001 GB  
rév. n° : 7  
date : 03/03  
page : 1/2

### General specification :

Lifting accessory in accordance with CE directives  
N°89/392 - 91/368 - 93/68 and European Standards N° EN 292 - EN 55 022  
- EN 50 082.2

Liquid cristal display (LCD) : 5 digits  
models LLX-0.25 to LLX-5 : 18 mm digits  
models LLX-12.5 to LLX-100 : 25 mm digits  
model LLX-250 : 44 mm digits

Ambient temperature range : -10°C to +40°C  
Temperature compensation : automatic zero adjustment when equipment  
free of any load is switched ON

Weatherproof and dustproof : IP65

Material : body in aluminium alloy

Finish : anodised black

Power supply : 3 x 1.5 V, AA or R6 (dia. 14 x 50 mm) standard

Power consumption : variable, depending on the  
setting of the functions

Battery life : 550 hours

Accuracy : +/- 0.2% of capacity

Operating coefficient : max. 2

Safety coefficient : 4



### Push-button controls :

- ON / OFF (T1)
- TARE (up to 100% of capacity) (T2)
- PEAK HOLD (T3)



T1



T2



T3

### Automatic functions :

- Automatic zero when switched on
- Low battery signal
- Overload indication

### Adjustable functions (using a sequence of operations of the push-buttons) :

- Choice of unit measurement : Unit display (kg, t, short ton, lbs, daN, kN)
- Automatic shutdown after 20 minutes with no addition/reduction of load
- Response rate of the display

### Output (BNC socket) :

- to connect to remote readout
- to connect to PC, for data processing and printing
- to connect to "Dynafor" printer

### Options :

- Remote hand held display suitable for use with all models (ON/OFF; tare, Peak hold).
- RS232 for connection to PC, Printer, etc.
- Portable DYNAFOR printer : customised print-out with date and time.
- Supply network

**technical  
sheet**

**DYNAFOR LLX  
LCD load indicators  
capacities : 250 kg to 250 t**

réf. : **T 2001 GB**  
rév. n° : **7**  
date : **03/03**  
page : **2/2**

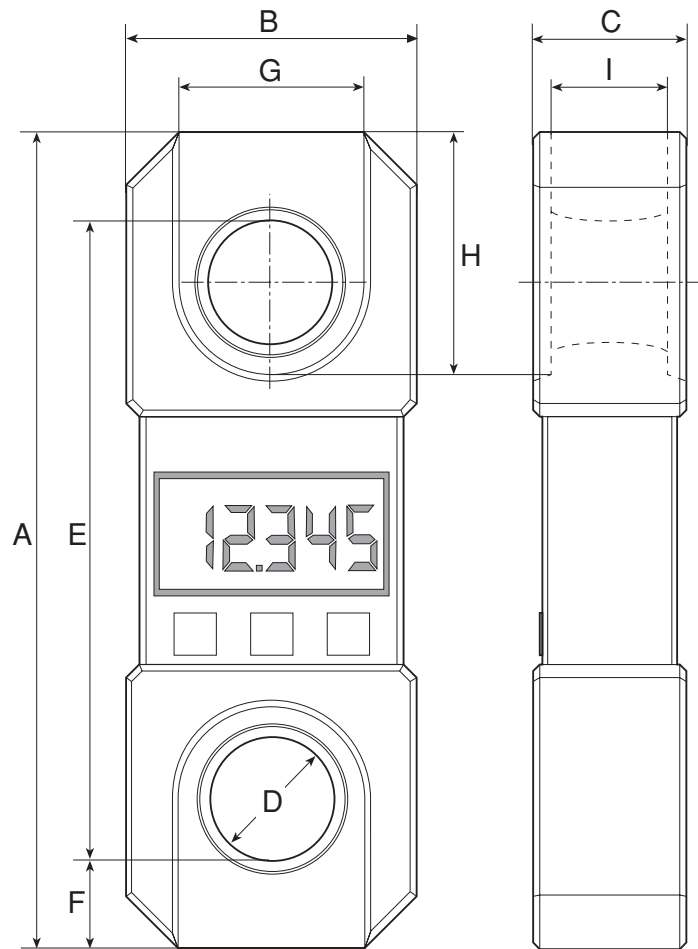

**Technical specification :**

Model		LLX-0.25	LLX-0.5	LLX-1.25	LLX-2.5	LLX-5	LLX-12.5	LLX-25	LLX-50	LLX-100	LLX-250	
Capacity	t	0.25	0.50	1.25	2.5	5	12.5	25	50	100	250	
Accuracy	±kg	0.5	1	2.5	5	10	25	50	100	200	500	
Smallest load increm.	kg	0.1	0.2	0.5	1	2	5	10	20	50	100	
Test load	t	0.5	1	2,5	5	10	25	50	85	145	333	
Max. display	kg/t	250.0	500.0	1250.0	2500	5000	12500	25000	50000	100.00	250,00	
Height of digits	mm	18	18	18	18	18	25	25	25	25	44	
Weight	kg	1.1	1.1	1.1	1.4	1.9	3.8	6.6	15.1	46	215	
Material		Aluminium alloy										
Dimensions	mm	A	190	190	190	214	226	310	360	440	660	905
		B	83	83	83	83	90	110	134	164	260	424
		C	56	56	56	56	56	58	68	98	118	248
		D	16	16	16	24	32	47	56	72	108	150
		E	166	166	166	184	197	243	272	332	488	685
		F	12	12	12	15	14,5	33,5	44	54	86	110
		G	47	47	47	47	54	70	84	104	174	250
		H	43	43	43	50	58	92	114	142	227	310
		I	16	16	16	25	32	48	58	86	104	190